

Pump Maintenance Procedure

- 1 Remove the Pump Valve Housing using number 15mm wrench
- 2 Remove the Pump Valve Housing and inspect the rotors for cracks and fouling. Replace as appropriate using Maintenance Procedure JC0346.
- 3 Prior to re-installation of the Pump Valve Housing, ensure the gasket is resealed with the correct gasket sealant.
- 4 Reinstall the Pump Valve Housing.
- 5 Reinstall the Pump Valve.

NOTE: Ensure that all bolts are tightened to 25 H·m.

- 6 Loosen the pump adjuster by 0.5 turn.



The Rotors cracks and fouling

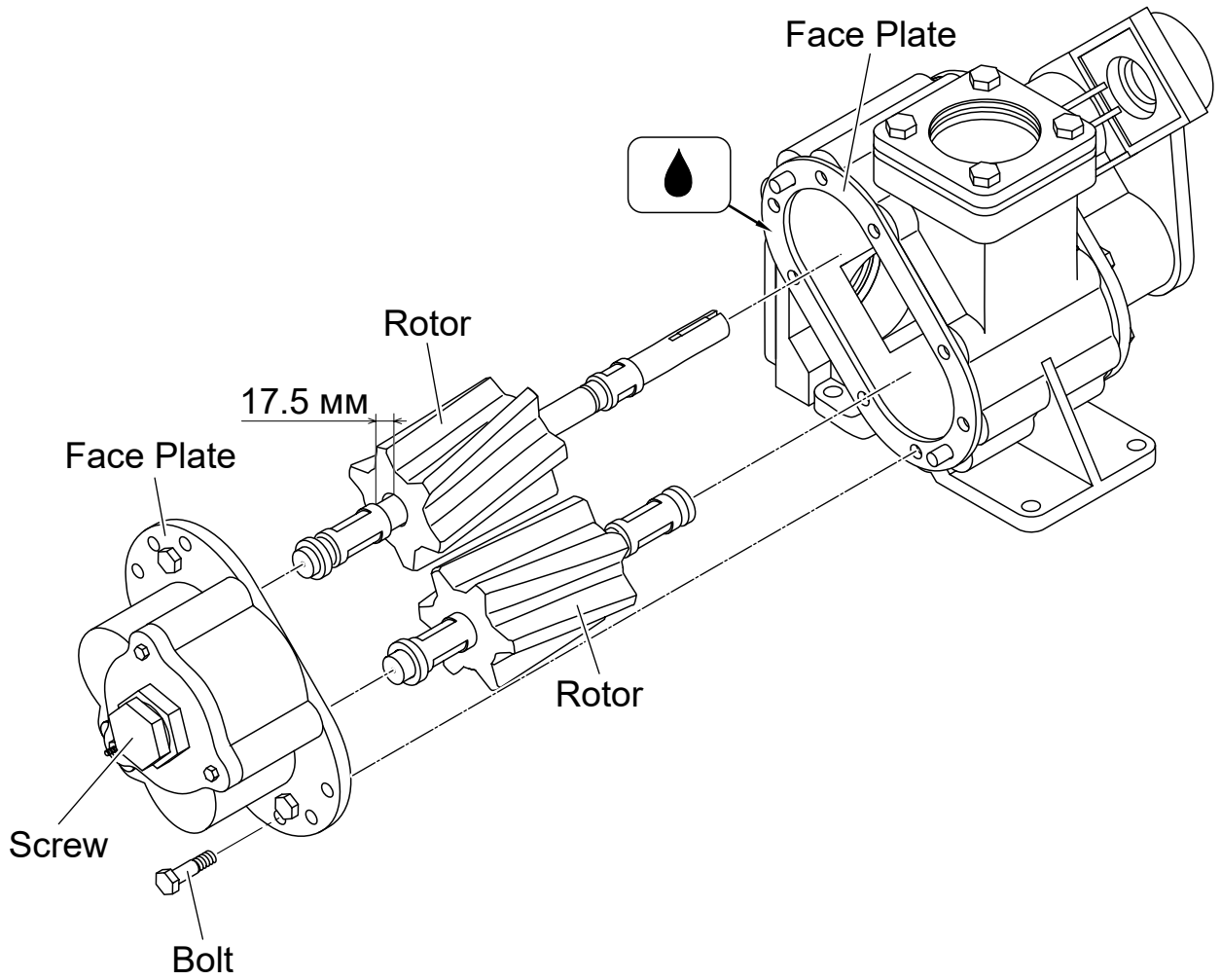

Pump