

# WHEELCHAIR ASSEMBLY

---

## 1. PREPARATION OF THE LEFT-HAND SIDE OF THE CHAIR

### a) ARMREST INSTALLATION

Install the armrest to the main frame [1] and secure it with two screws [2] and washers [3].

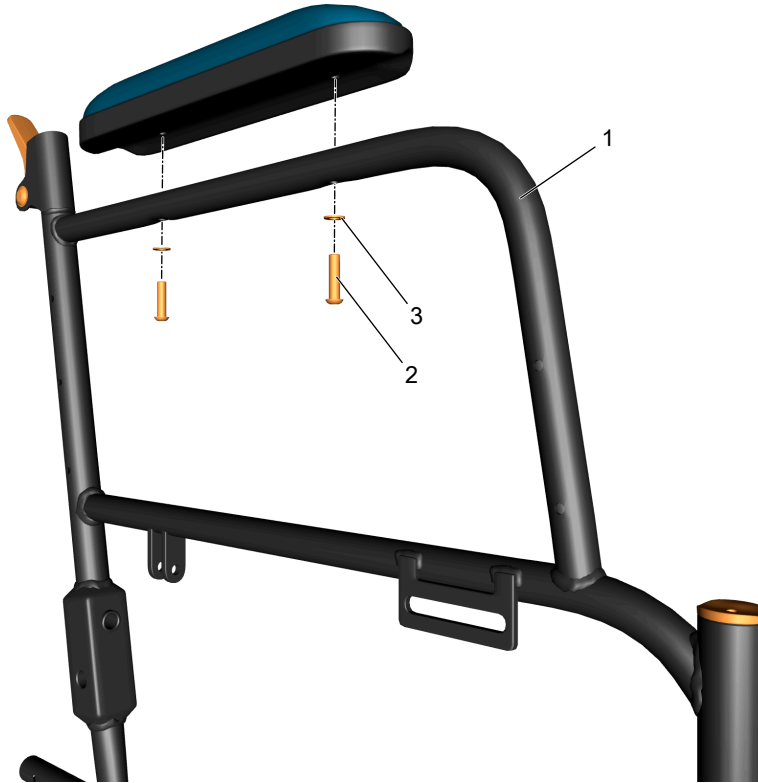

### b) SIDE WALL INSTALLATION

Install the side wall [4] to the main frame [1] and secure it with the five screws [5] and washers [6].

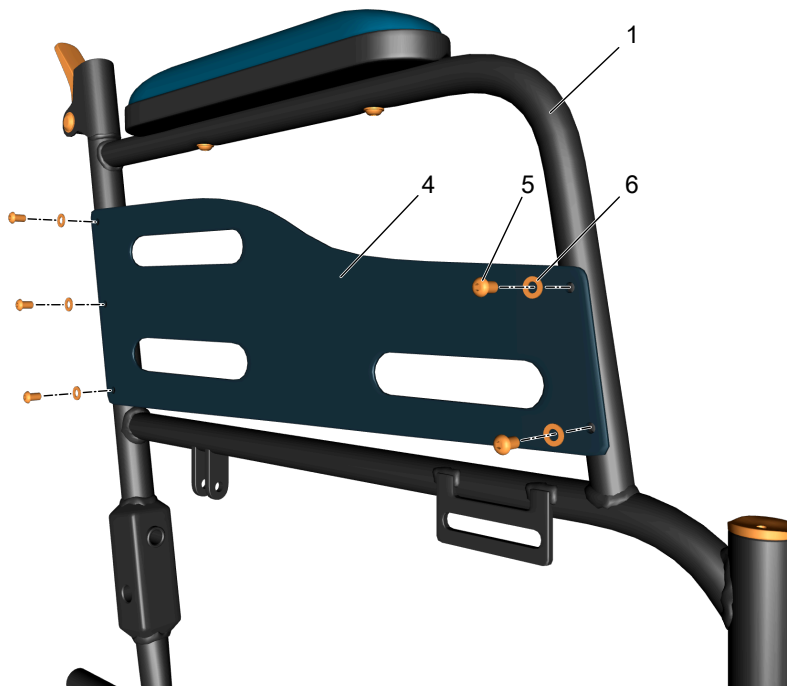

c) **PREPARATION OF THE MAIN WHEEL ASSEMBLY**

Install the axle bolt [7] in the main wheel hub and secure it with the nut [8]. Then install a washer [9] on the bolt.



d) **INSTALLATION OF THE MAIN WHEEL ASSEMBLY**

Install the prepared main wheel assembly into the hole in the main frame [1] and secure it with a washer [10] and a nut [11].

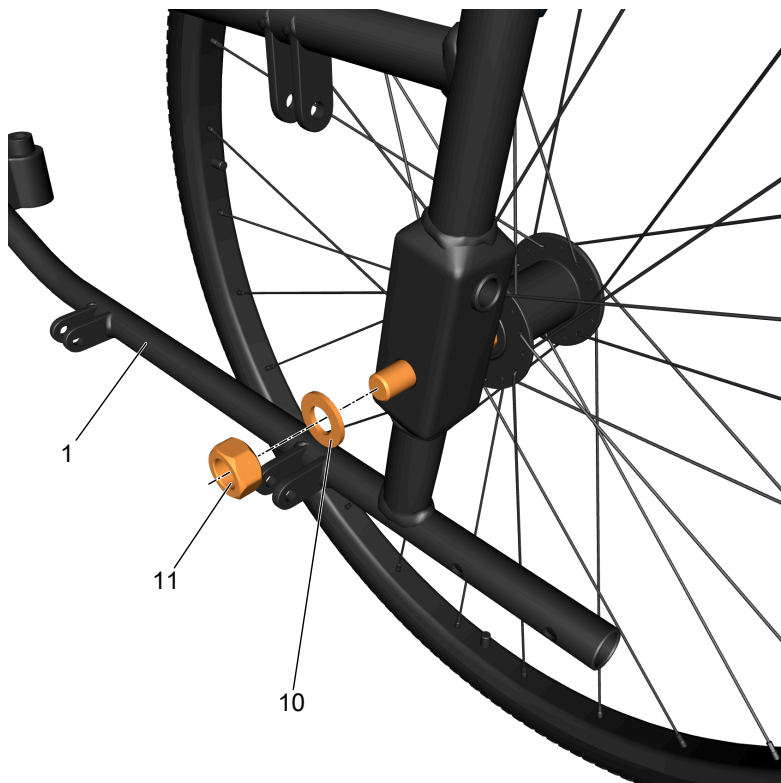

e) **INSTALLATION OF THE HAND RIM OF THE MAIN WHEEL**

Install the hand rim [12] by aligning the rim brackets with the pins on the main wheel rim and secure it with the nuts [13].

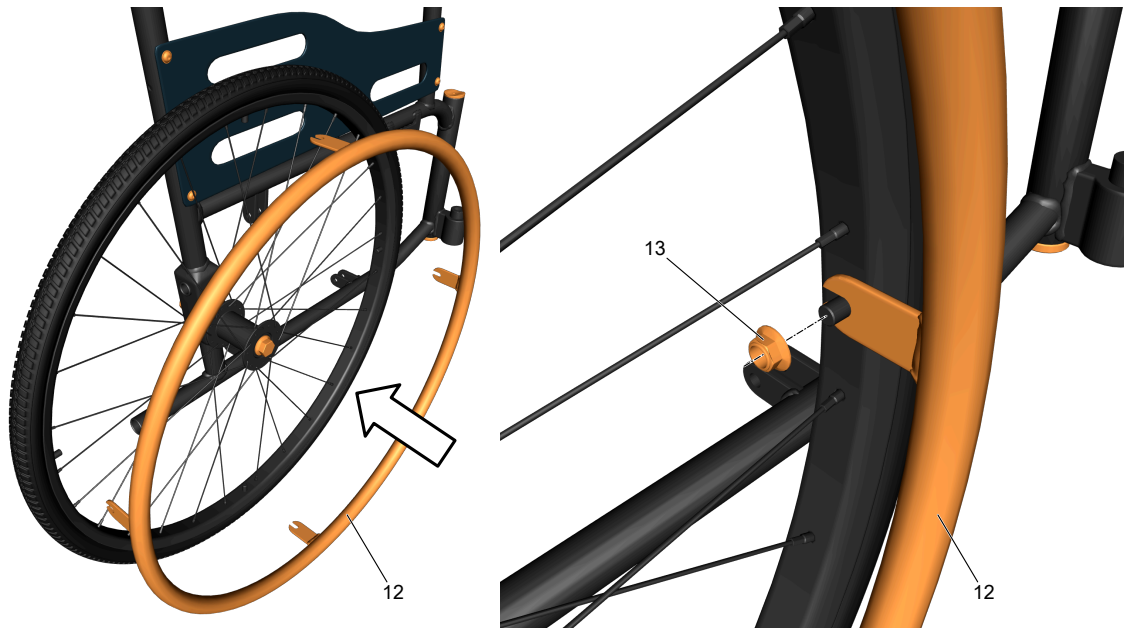

f) **COUPLING ROD INSTALLATION**

Insert the coupling rod [14] into the rear hole of the main frame [1], aligning the holes in the rod with the holes in the main frame. Secure the fitted coupling rod with a bolt [15], two washers [16] and a nut [17].

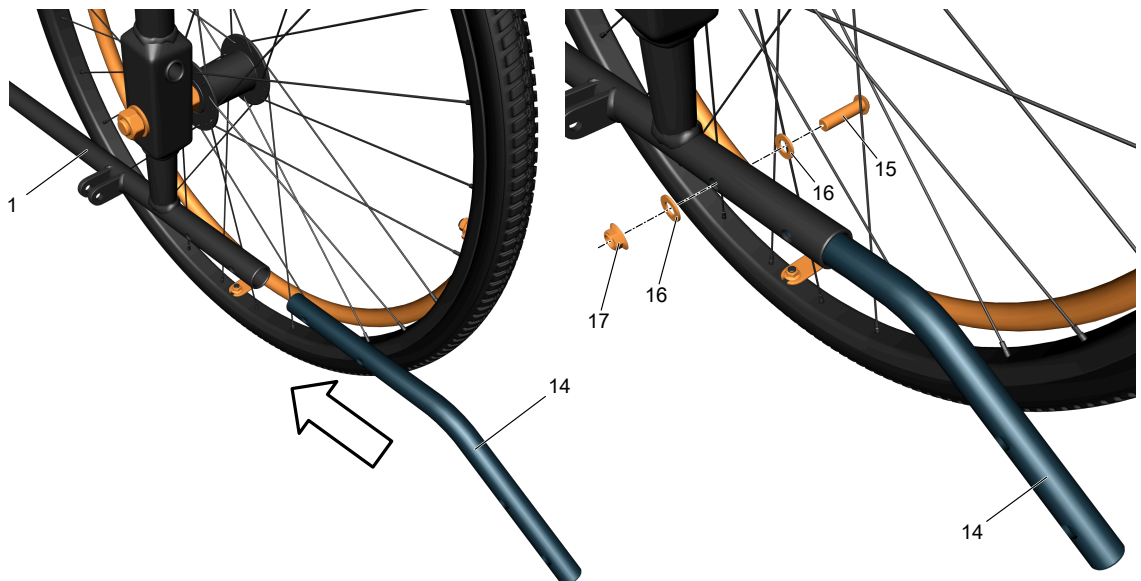

**Note:** There are two holes on the coupling rod [14] for length adjustment.

g) **PREPARATION OF THE ANTI-TIP CASTER ASSEMBLY**

Insert the slide bearing [18] into the caster wheel [19]. Insert the resulting assembly into the hole at the end of the anti-tip caster barbell [20] and secure it with a bolt [21] and nut [22].

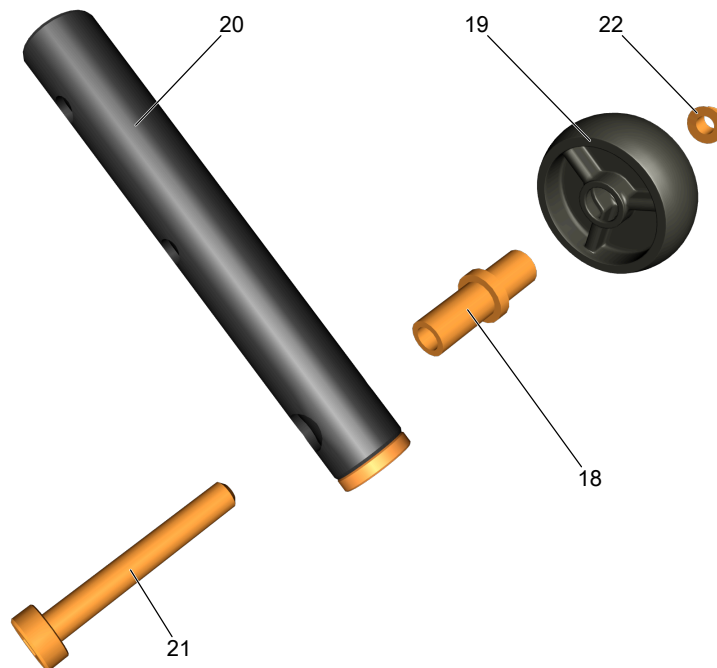

h) **INSTALLATION OF THE ANTI-TIP CASTER ASSEMBLY**

Slide the anti-tip caster assembly onto the coupling rod [14] by aligning the holes of the coupling rod [14] with the holes of the caster barbell [20]. Secure the installed caster assembly with a bolt [23], two washers [24] and a nut [25].

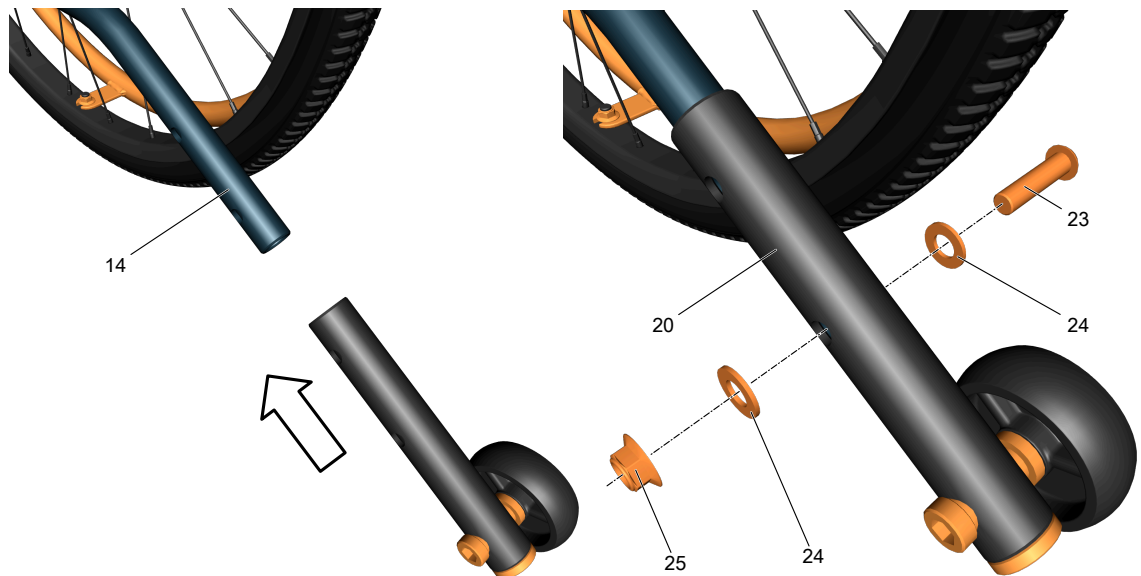

i) **THE CASTER WHEEL AXIS INSTALLATION**

Install the caster wheel axis [26] into the hole of the sleeve located at the front of the main frame and mount the nut [27] on it.

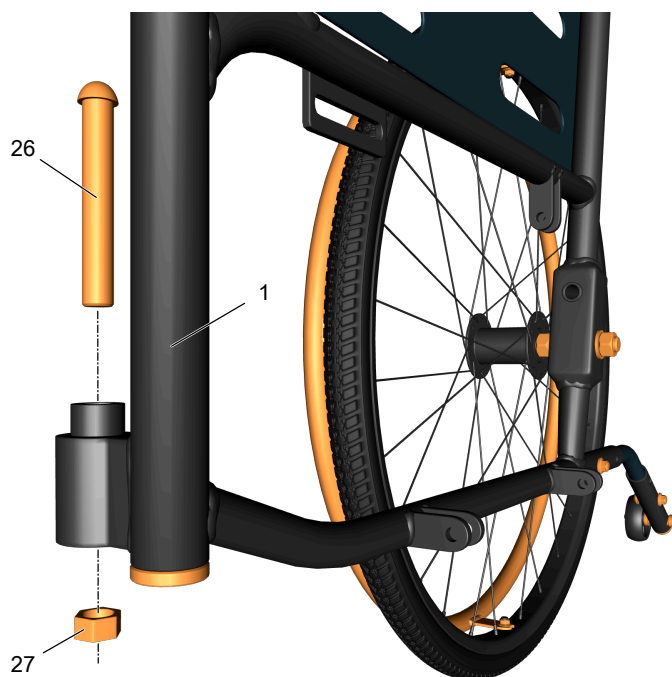

**Note:** There should be a 3mm gap between the bottom edge of the sleeve and the nut [27]. This clearance will ensure that, the caster wheel rotates freely while using the chair.

j) **PREPARATION OF THE CASTER WHEEL ASSEMBLY**

Insert the caster wheel sleeve [28] into the hole of the caster disc [29], then put the resulting assembly into the caster wheel fork [30] and secure it with a bolt [31], two washers [32] and a nut [33].

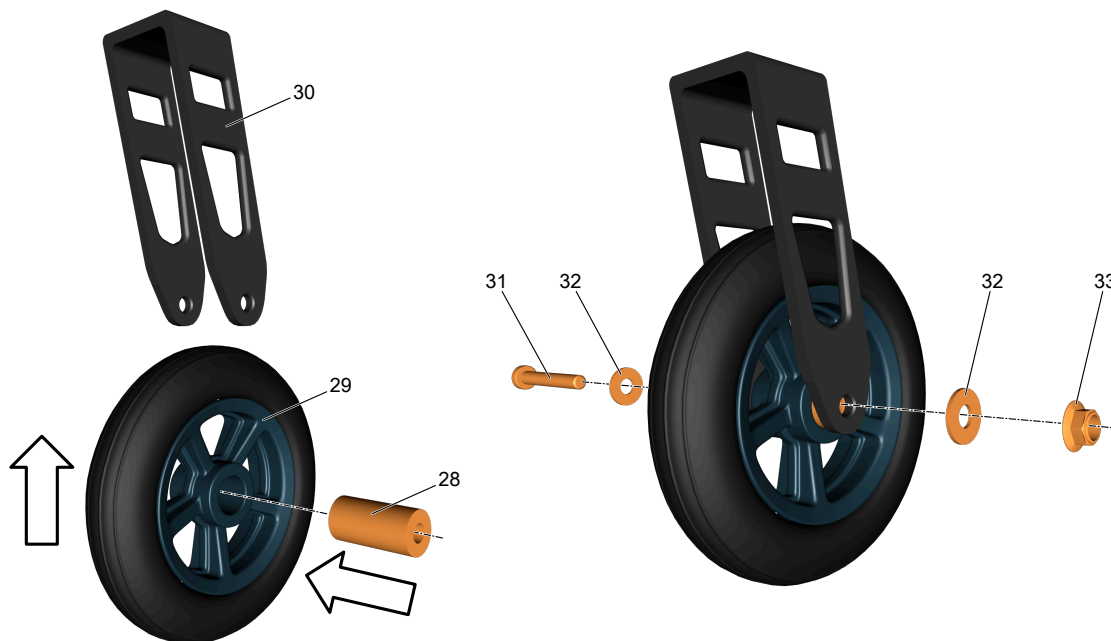

k) **INSTALLATION OF THE CASTER WHEEL ASSEMBLY**

Fix the caster wheel assembly to the caster wheel axis [26] using a nut [34].

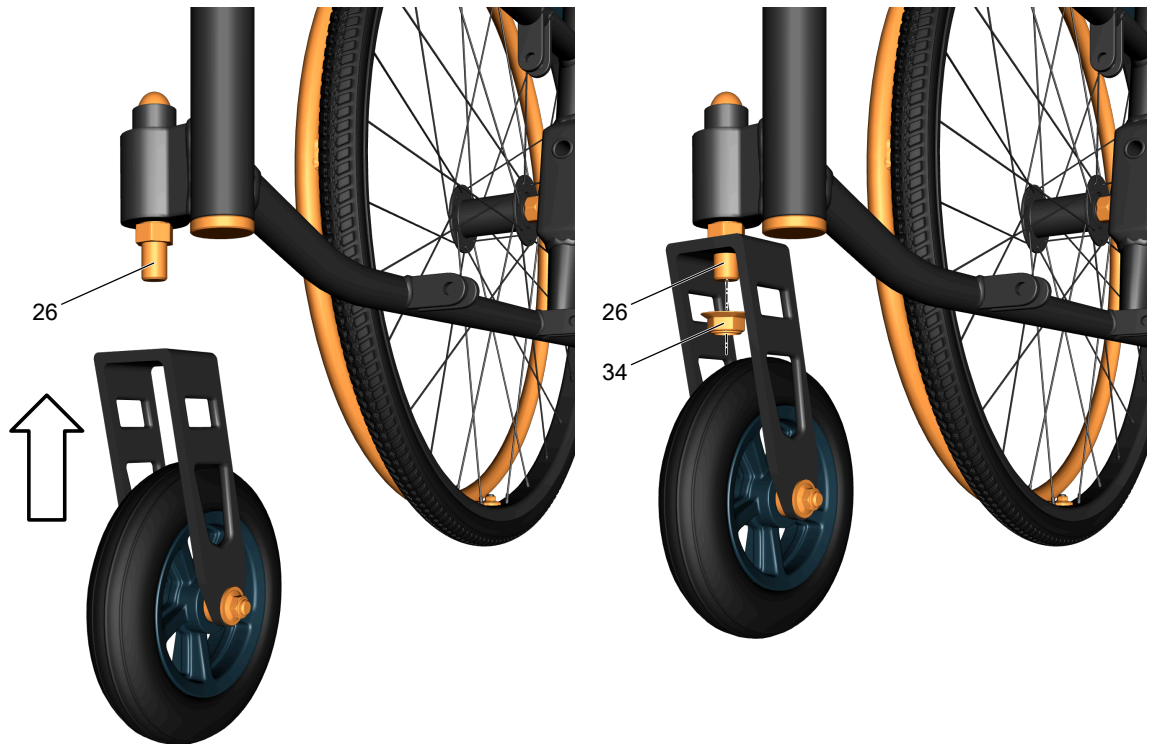

l) **FRONT BRAKE ASSEMBLY INSTALLATION**

Install the front brake assembly [35] to the bracket [36] welded to the main frame [1] using two bolts [37], four washers [38] and two nuts [39].

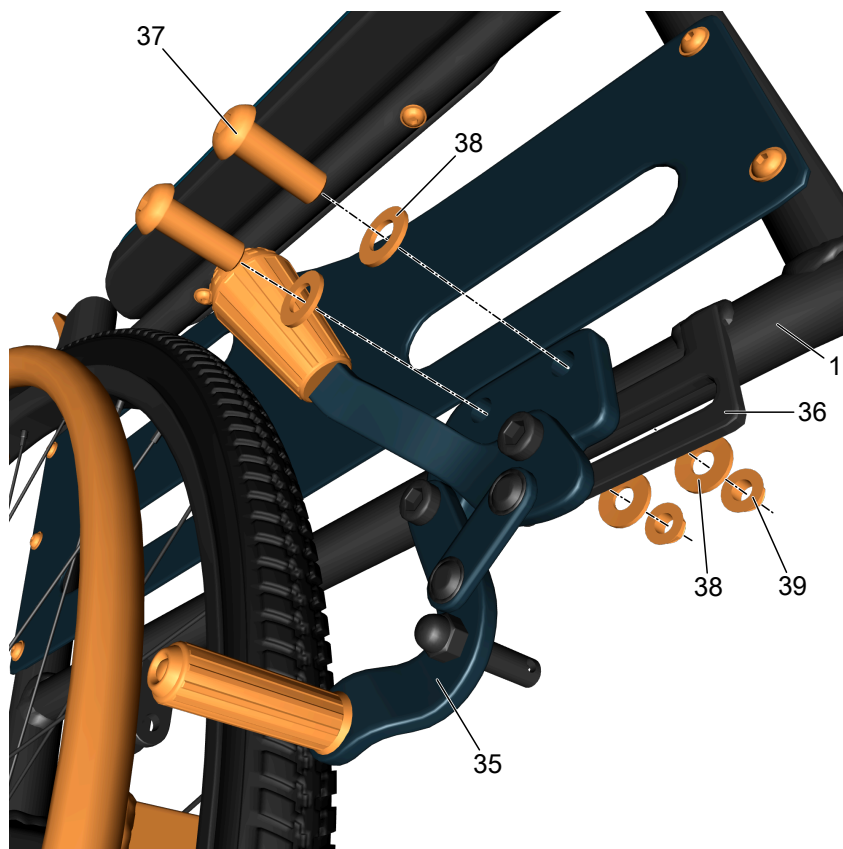

**Note:** The FRONT BRAKE ASSEMBLY comes preassembled.

### m) PUSH ROD INSTALLATION

Bend the lock lever [40] and insert the push rod [42] into the upper hole in the main frame [1]. Push it down until the lock pin [41] fits into the adjustment hole on the push rod [42].

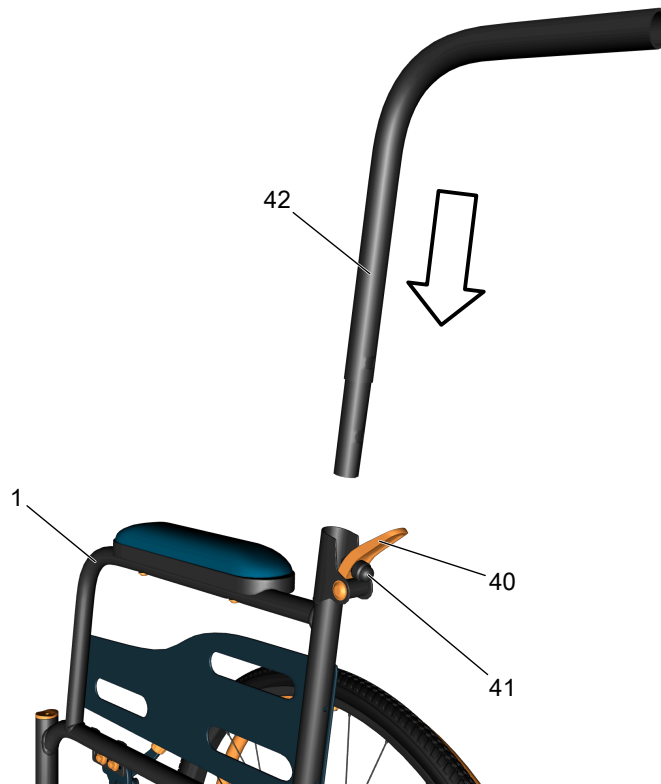

**Note:** There are two holes on the push rod [42] for height adjustment.

### n) HAND BRAKE ASSEMBLY INSTALLATION

Slide the brake assembly [43] onto the push rod [42]. Thread the brake rope [44] through the hole in the main frame [1], and then through the hole in the front brake assembly lock screw [45].

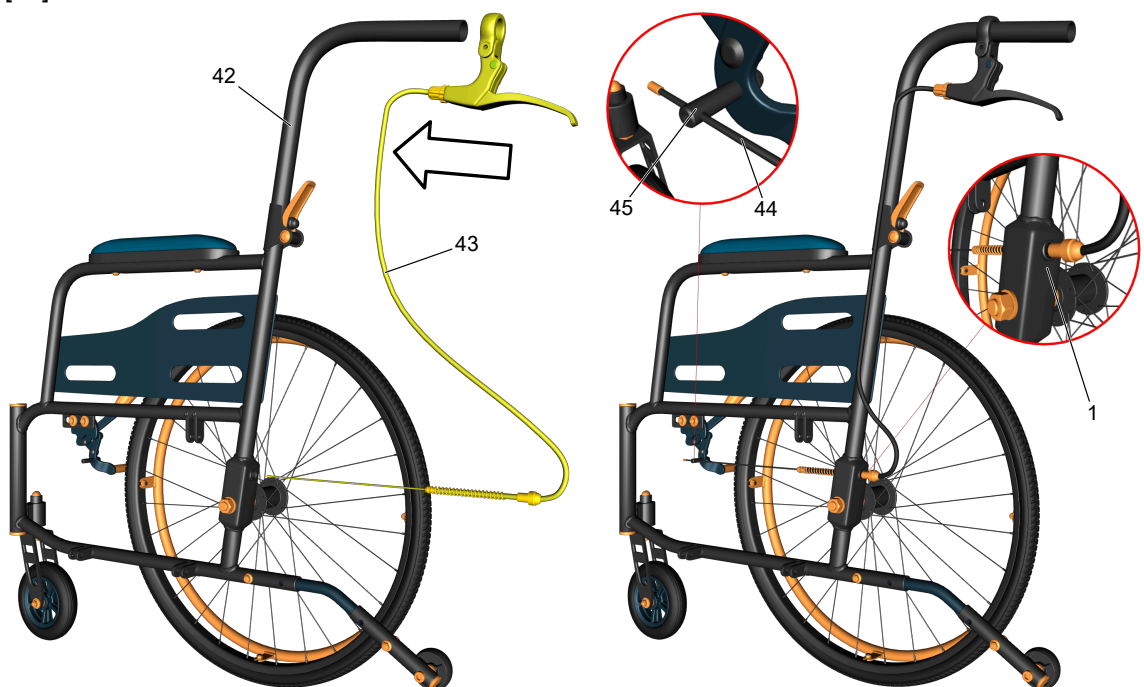

Secure the brake handle [46] with the screw [47]. Put the hand grip [48] on the end of the push rod [42]. Screw the spring lock [49] into the hole in the main frame [1]. Use the screw [50] to secure the brake rope [44] in the lock screw [45].

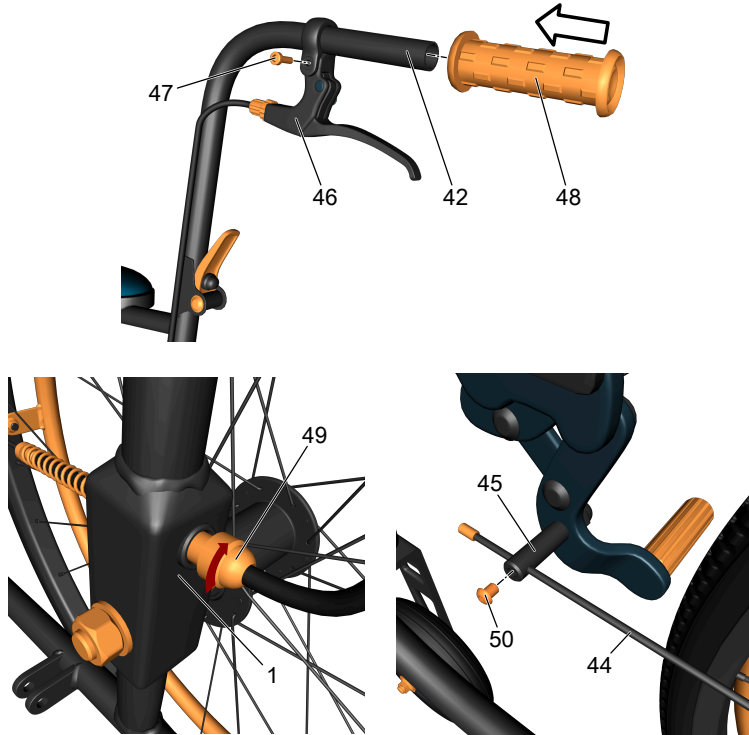

**Note:** The HAND BRAKE ASSEMBLY comes preassembled.

#### o) HAND BRAKE TEST

Press the brake handle lever [51] down. The front brake pin [52] should press firmly against the main wheel [53] and lock it securely. If this does not happen, adjust the handbrake according to the instructions supplied with the handbrake assembly.

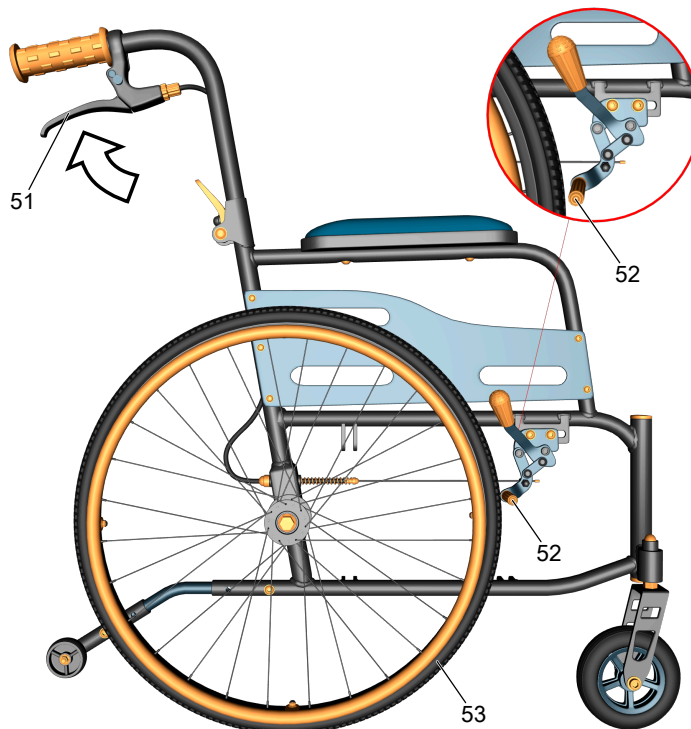

p) **FOOTREST PREPARATION**

Slide one end of the leg belt [55] onto the footrest frame [54]. Then screw the joint [56] into the bottom of the footrest frame [54]. Attach the footrest plate [57] to the joint [56] so that the holes in the joint align with the holes in the footrest plate. Secure the above connection with the screw [58]. Screw the pin [59] into the footrest plate [57] by inserting it into the other end of the leg belt [55].

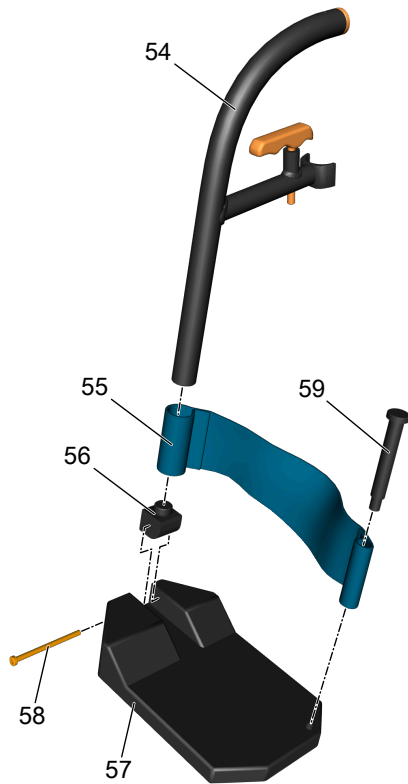

q) **FOOTREST INSTALLATION**

Attach the footrest [60] to the main frame [1] and secure the footrest with the screw [61]. Put the retainer [62] on the main frame [1] and fix it with the retainer brace [63] and screw [64]. When securing the retainer, ensure that the retainer pin [65] fits into the hole in the retainer [62].

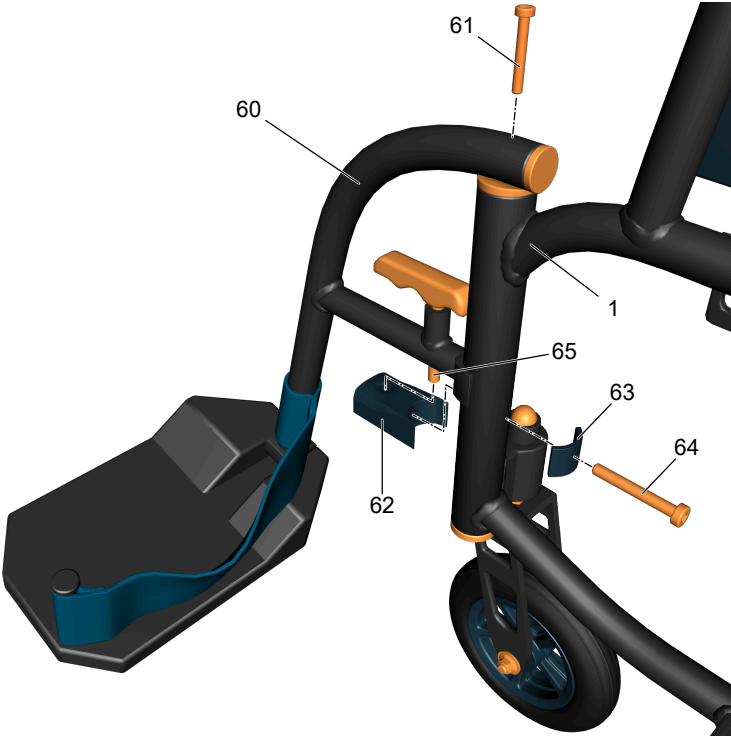

### r) FOLDING FRAME INSTALLATION

Place the elbow [66] on the main frame [1] and secure it with the bolt [67], washer [68] and nut [69]. Then mount the folding frame [70] on the elbow [66] with a bolt [70], two washers [71] and a nut [72].

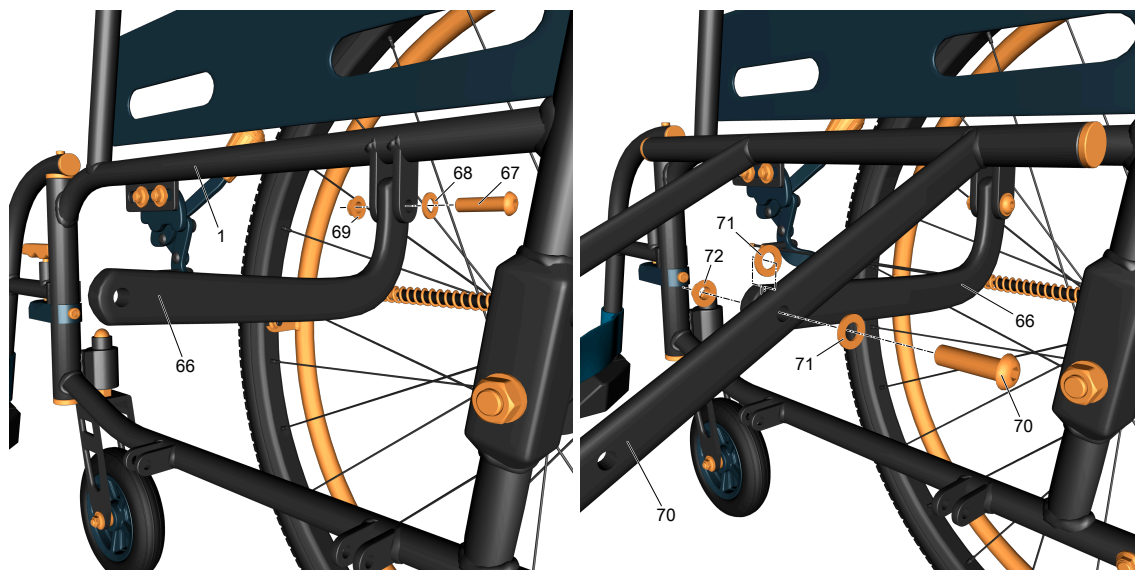

**Note:** One washer [71] must be placed between the elbow [66] and the folding frame [70]. Do not overtighten the screws, but leave small gaps ( $\approx 1\text{mm}$ ) between the parts to allow the folding frame [70] to rotate freely in relation to the elbow [66].

### 2. PREPARATION OF THE RIGHT-HAND SIDE OF THE CHAIR

Repeat all the operations from step 1 of this manual with the right-hand side of the chair.

### 3. LINKAGE THE LEFT AND RIGHT PARTS OF THE CHAIR

Slide both parts of the chair toward each other so that the holes in the folding frames [70] align with the holes in the brackets [73] on the main frames [1]. Fasten both parts of the chair with bolts [74], washers [75] and nuts [76].



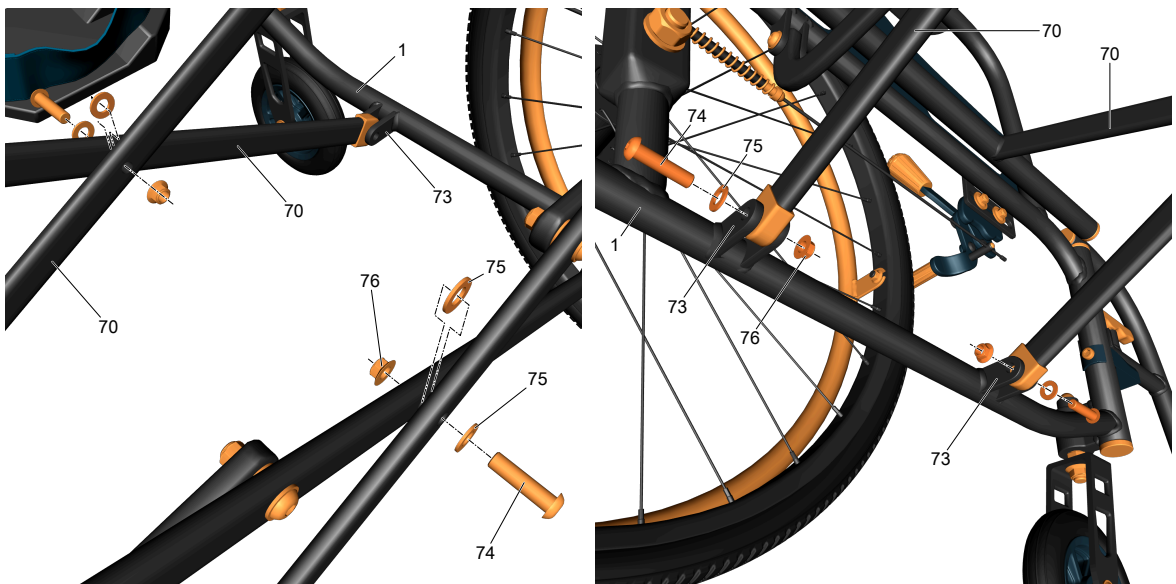

**Note:** Two washers [75] in the connection of the folding frames [70] must be placed between the frames.

#### 4. SEAT INSTALLATION

##### a) BACKREST INSTALLATION

Position the backrest [77] on the chair so that the holes in the backrest align with the holes in the main frames [1] and the upper "arms" of the backrest with Velcro around the push rods [42]. Fasten the backrest [77] with four screws [78], four washers [79] and Velcro.



**b) SEAT INSTALLATION**

Install the seat [80] so that the arms of the seat with Velcro wrap around the horizontal stops of the folding frames [70]. Secure the seat [80] with Velcro.

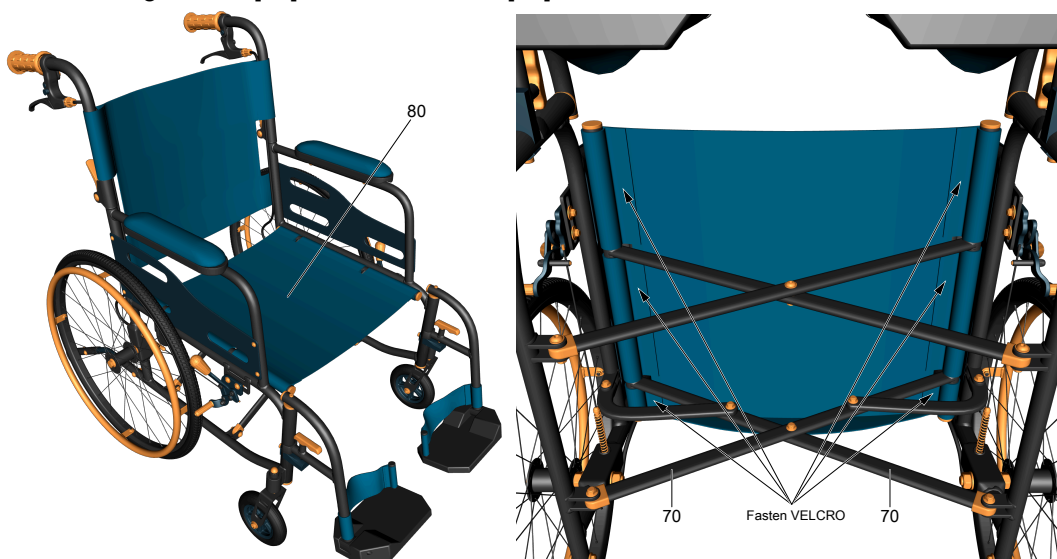

**c) SEAT CUSHIONS INSTALLATION**

Put the cushion [81] on the seat [80] and secure it with Velcro. Install the cushion [82] on the backrest [77] and secure it with Velcro.

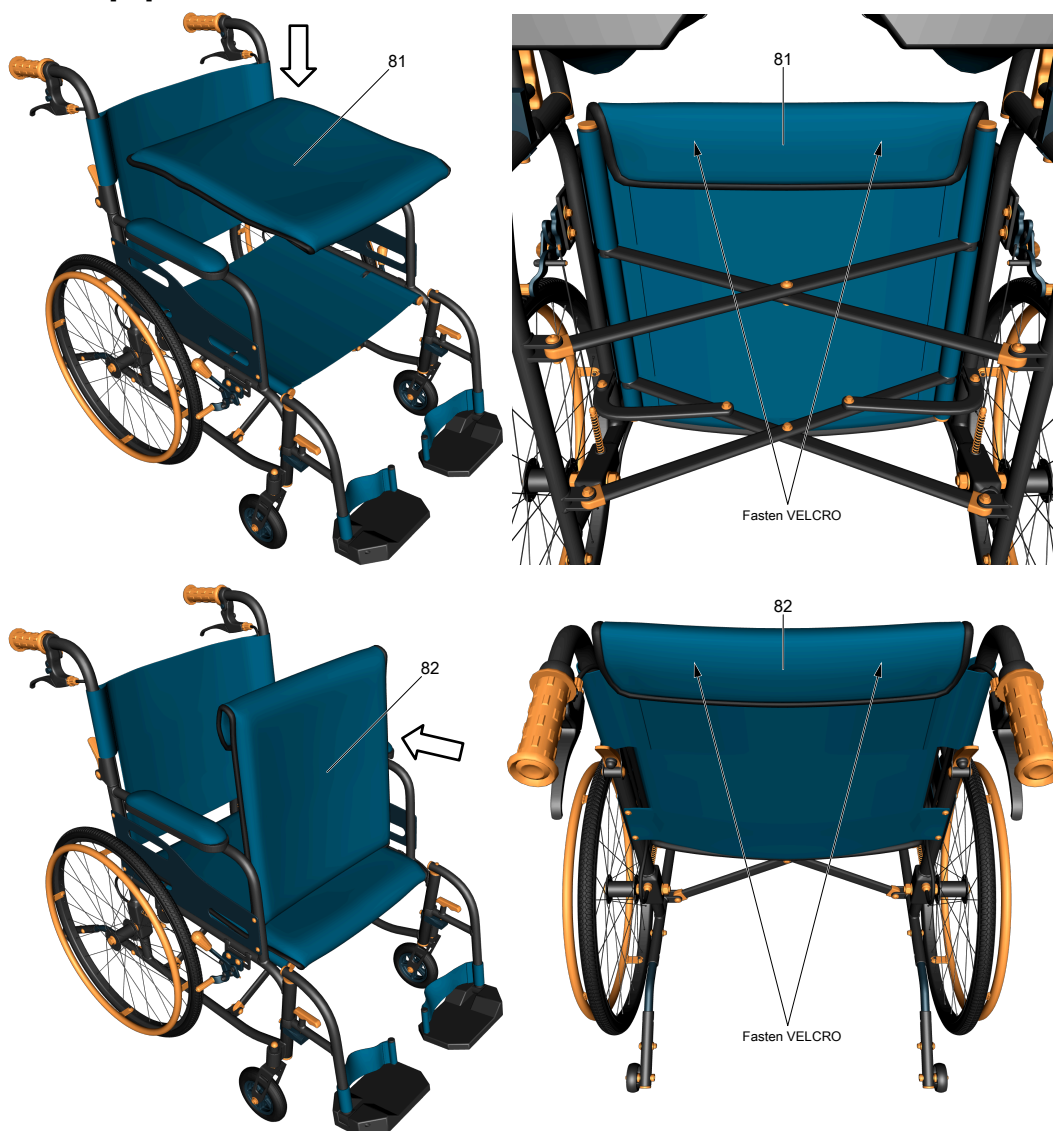

## 5. THE WHEELCHAIR REVIEW

